

NOTES:

1. VENDOR: INSTALL GAGE & TEST BEFORE SHIPING. ENGAGE BRAKE & INSURE BREAK HOLDS 600 TO 1500 PSI WITHOUT SLIPAGE. REMOVE GAGE AFTER TESTING & PLUG. : IMPORTANT, SYSTEM MUST BE AIR FREE BEFORE PLUGGING.
2. USE LOC-TITE #242 OR EQUAL ON SET SCREWS (17, 18, 19, 29), AND THREADED END OF HANDLE (47).
3. USE LOC-TITE #262 (PERMANENT) ON SOCKET HEAD CAP SCREW (21), AND SET SCREW (33) HANDLE ONLY.
4. LUBRICATE BRAKE TANG (2), PISTONS (4 & 6), MAIN SHAFT (5), PLUNGER (11), THREADS OF STEM (14), BEARINGS (16 & 44), PISTON GUIDE (27) AND O-RINGS (35 & 46) WITH LUBRIPLATE 105 OR EQUAL.
5. FILL LOAD CELL (7) WITH HYDRAULIC FLUID.
7. PLUG ITEM 20 IS PROVIDED WITH O-RING P/N GIVEN FOR REF ONLY.
8. USE A LIGHT COAT OF SILICONE SEALANT BETWEEN ITEMS 1 AND 3.
9. APPROXIMATE WEIGHT : 22 LBS
10. NOT SHOWN.
11. 00-1113-0002-00 OR EQUAL TO.
12. SET SCREW 28-8503-4580-10 IS TO BE INSERTED INTO HANDLE WITH #242 LOCTITE, AND IS TO EXTEND .312 FROM END OF HANDLE LET LOCTITE SET UP BEFORE ASSY. IN LOAD CELL.

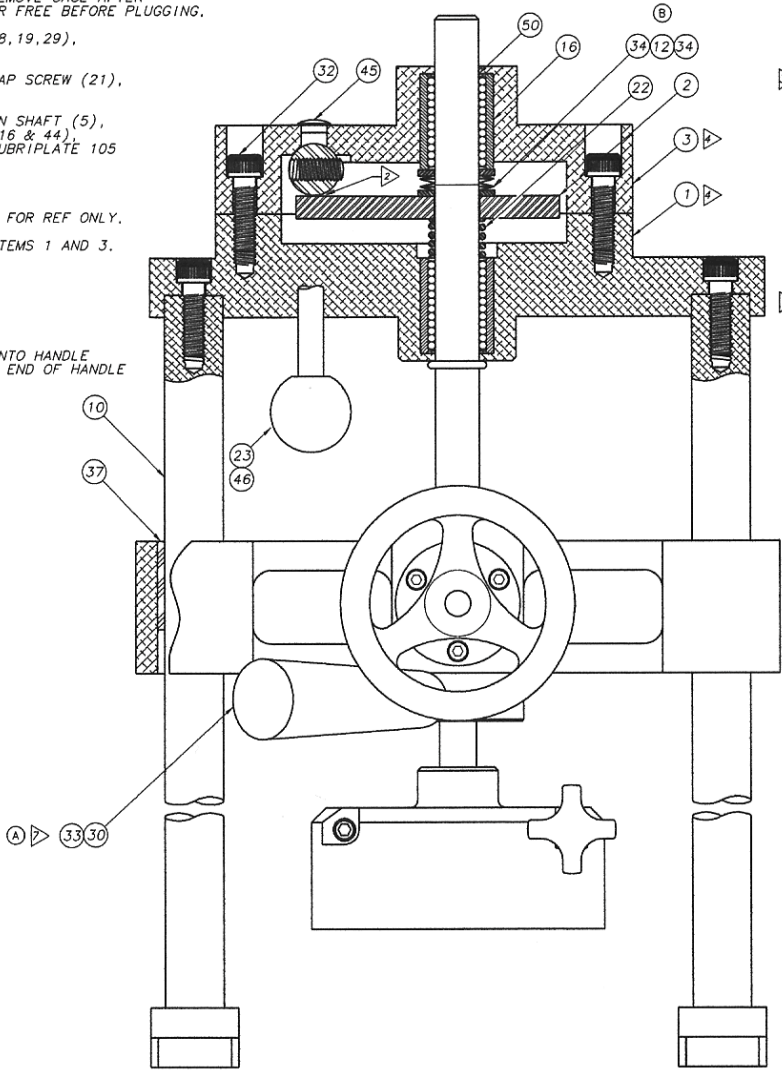
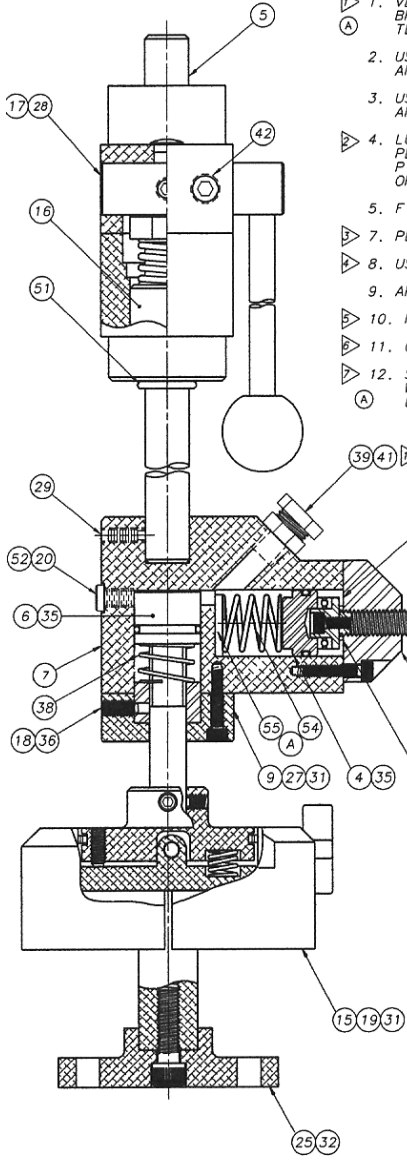

56	1	DECAL, TDW	00-0912-0001
55	1	WASHER	28-8520-2500-1G
54	1	SPRING	28-8579-0600-1G
53	1	O-RING, (5-613)	00-6568-0013-0G
52	0	O-RING, (3-902)	00-6568-0010-0G
51	1	O-RING, .13 BUNA N	00-0117-0002-0G
50	2	O-RING, .07 BUNA N	00-0115-0008-0G
49	1	KEY, HEX, (3/16)	28-8530-0500-1G
48	1	KEY, HEX, (5/16)	28-8530-0800-1G
47	4	SCREW, SOC HD CAP, (.375-16)	28-8501-4200-1G
46	1	SHAFT, BRAKE HANDLE	28-8602-8470-2
45	1	PLUG, FINISHING	28-8585-0200-1
44	1	BEARING, BALL THRUST	00-0992-0009-0
43			
42	1	PLUNGER	28-8547-0800-1
41	1	PLUG 1/4 NPT	SEE NOTE
40			
39	1	ADAPTER, (2040-4-4S)	00-0699-0167-0
38	1	SPRING, COMPRESSION	28-8579-0800-1
37	2	BUSHING, ARM	00-6991-0001-0
36	1	PLUG, HOLLOW .250*20	28-8585-0150-1
35	2	O-RING, .094 BUNA-N	00-0116-0017-0
34	2	WASHER, .750* AERONAUTICAL	28-8520-0300-1
33	1	SCREW, SET .312*18x1.00*LG	28-8503-4580-1
32	6	SCREW, SHC .375*-16x1.25*LG	00-0760-0600-1
31	7	SCREW, SHC #10-24x1.00*LG	00-0760-0300-0
30	1	HANDLE, LOAD CELL	28-8568-3950-1
29	1	SCREW, SET .25-20UNC .50*LG	00-5545-0007-0
28	1	SHAFT, ANNULAR BRAKE	28-8602-8280-2
27	1	BEARING, PISTON GUIDE	28-8602-8270-2
26	1	PIN, SPRING .188"x.875*LG	00-0215-0011-0
25	2	FOOT, MOUNTING	28-8602-4670-2
24			
23	1	KNOB, PLASTIC PRESS-ON	28-8568-3320-1
22	1	SPRING, COMPRESSION	28-8579-0500-1
21	1	SCREW, SHC #10-24X .75*LG	28-8501-0590-1
20	1	O-RING PLUG (FF2138-25)	00-0699-0316-0
19	1	SCREW, SET F-P .25*-20x.375*	00-0020-0400-0
18	1	SCREW, H-D SET .25*-20x.50*	28-8503-4700-1
17	1	SCREW, OVAL PT SET .375*-16	28-8503-5400-1
16	2	BEARING, LINEAR	28-8539-0550-1
15	1	HOLDER RELEASE ASSEMBLY	28-8602-8150-3
14	1	STEM, HANDLE	28-8602-8140-2
13	1	WHEEL, HAND	28-8602-8130-2
12	4	WASHER, BELLEVILLE	28-8602-8430-1
11	1	PLUNGER, PISTON	28-8602-8110-2
10	2	SUPPORT	28-8602-8100-2
9	1	RETAINER, VERTICAL PISTON	28-8602-8090-2
8	1	RETAINER, HORIZONTAL PISTON	28-8602-8080-2
7	1	BODY, LOAD CELL	28-8602-8480-2
6	1	PISTON, VERTICAL FORCE	28-8602-8060-2
5	1	SHAFT, MAIN	28-8602-8410-2
4	1	PISTON, HORIZONTAL FORCE	28-8602-8040-2
3	1	PLATE, BRAKE COVER	28-8602-8030-2
2	1	PLATE, BRAKING	28-8602-8020-2
1	1	BODY	28-8602-8010-2

LTN	ECN	DESCRIPTION	CHK DATE	BY	LTN	ECN	DESCRIPTION	CHK DATE	BY
	C	5855	ADDED ITEM 19 TO BOM	9/22					
	B	4435	WAS SPRING, FLAT DISK P/N 28-8579-0750-10	13AUG98					
	A	4349	ADDED 54 & 55 CHANGED PN 38	03JUNE98					
		4178	ADDED NOTE 12						
	-	4235	NEW DWG	01APR98					

DIMENSIONING AND TOLERANCING PER ANSI Y14.5M

POSITION PERPENDICULARITY PARALLELISM FLATNESS CONCENTRICITY CIRCULAR RUNOUT TOTAL RUNOUT SYMMETRICAL STRAIGHTNESS CIRCULARITY

SYM MODIFIER

MAC MAX MATL COND UNLESS OTHERWISE SPECIFIED TOLERANCES ARE PER TITLE BLOCK. 125 FINISH ALL MACHINED SURFACES. BREAK ALL SHARP CORNERS .03 CHAMFER/RADIUS MAX X.XX (2) PLACES ±.03 X.XXX (3) PLACES ±.015 ANGULAR TOLERANCE ±.5°

DATE: 31MAR98

SCALE: 1/2"

CHK BY: RDP

APVD: RDP

DWG NO: 28-8602-8450-30 SH 1

T.D. WILLIAMSON, INC. TULSA OKLAHOMA U.S.A.

OUTRIDER 1500A (WITH OUT GAGE)